

# TOP

3-axis adjustable hinges for timber main entrance doors



- 16 and 20 mm diameter
- 120 kg max. capacity
- Stainless steel pin
- Ball bearing

## TOP 3-axis adjustable hinges for timber main entrance doors

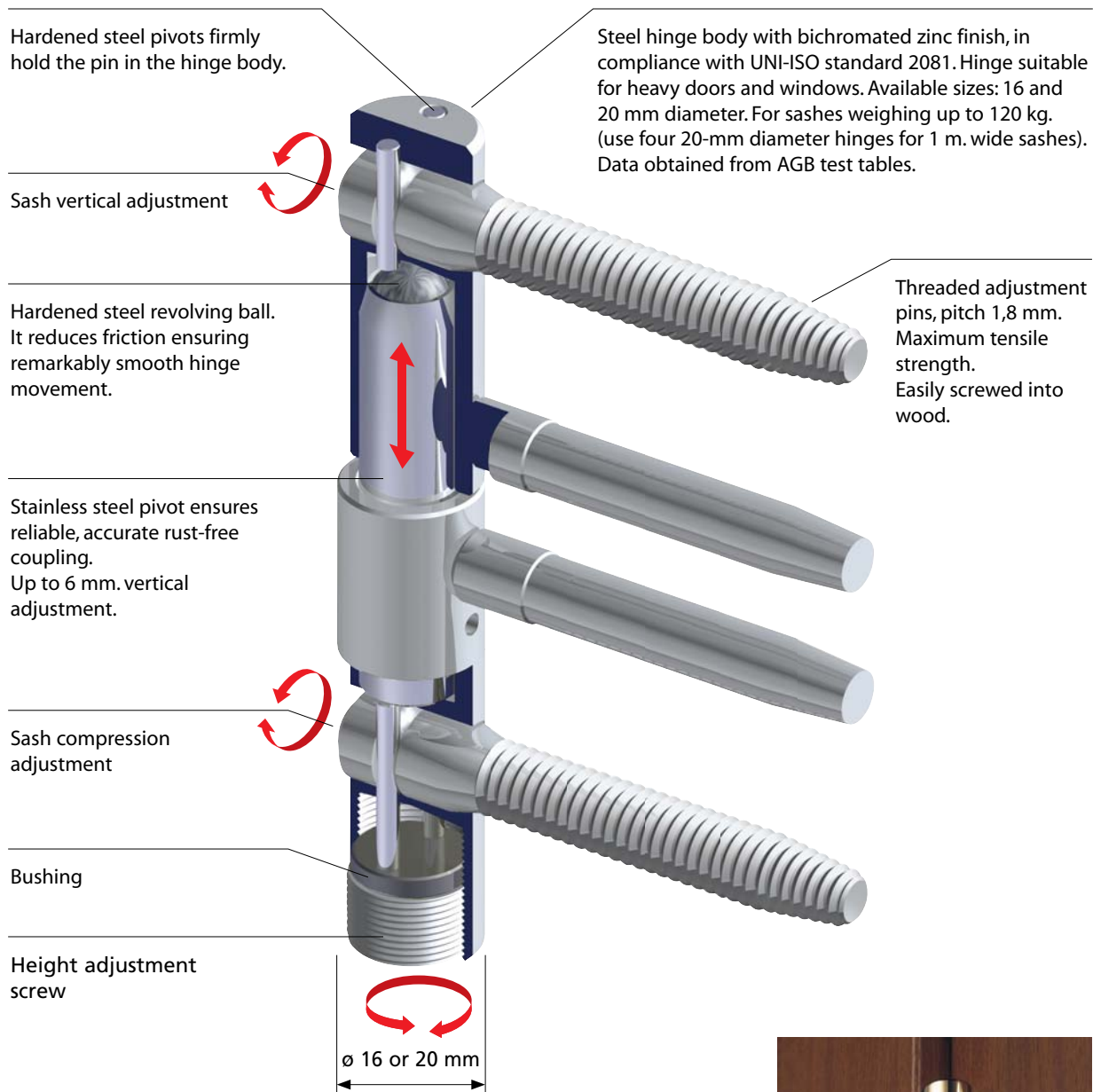

- The vertical adjustment allows for uniform load distribution on the hinges. The thrust is achieved by means of two hardened steel pivots and a bushing which ensures easy adjustment of even the heaviest sashes.
- The adjustment is extremely stable since it is independent of the hinge rotation movement. It can be executed even after the sash and frame have been mounted.
- All adjustments are made using a 5 mm Allen keys.
- Jigs for flush and rebated assembly are also available.



ABS covers are available with the following finishes: nickel plated, light bronze plated, brass plated, black, brown and silver plated.