



Open, Close, Live

## **TOUR** - RECTANGULAR PIVOT WINDOW

OPERATION AND MAINTENANCE MANUAL



# TOUR - Rectangular pivot window - Operation and maintenance manual

## Tips

Pivot window provides great benefits thanks to the central pivot opening that does not interfere with furniture and objects inside the room. It also provides excellent air circulation thanks to the micro-ventilation opening that allows hot air to get out from the top opening and fresh air to get in from the bottom opening. The fact that the sash can rotate 180° makes it easy to clean.

## Functioning

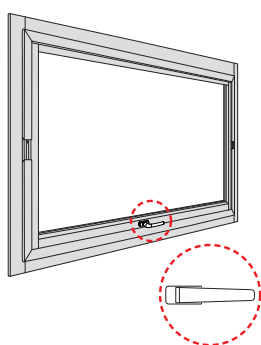

CLOSED POSITION  
HANDLE HORIZONTAL

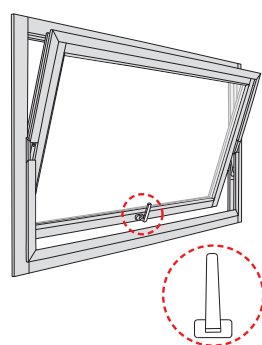

OPEN POSITION  
HANDLE VERTICAL

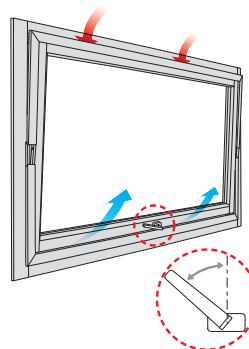

POSITION OF MICRO-VENTILATION  
HANDLE AT 50°  
This position is not in a  
safety lock position

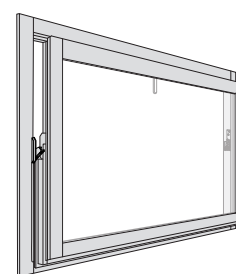

WINDOW TURNED 180°  
FOR GLASS CLEANING

## Warnings

to prevent window damage and personal injury.

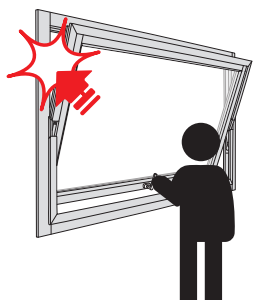

Do not slam the sash against the frame.

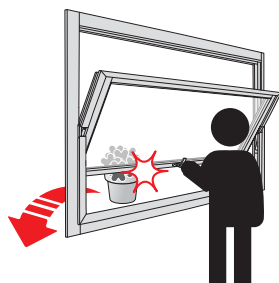

Do not obstruct window opening and closing with foreign objects.

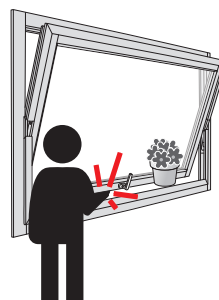

Do not place any body parts or objects between the sash and frame (as this could result in injuries).

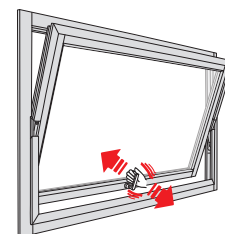

Do not force anything: In case of a problem, check to see if there is misalignment or if something is obstructing the path of the moving parts.



Do not overload the sash. Hinge capacity varies depending on the model

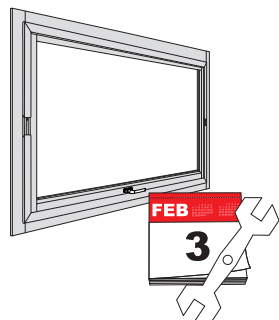

Call on qualified technicians to perform periodic maintenance tasks



Caution! Do not lean out of the window. Risk of falling and personal injury.

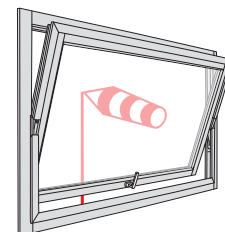

Close the sash against wind, breezes etc.

## Maintenance

To ensure hardware durability and performance, don't neglect proper maintenance tasks. All mechanisms should be checked at least once a year by qualified personnel.

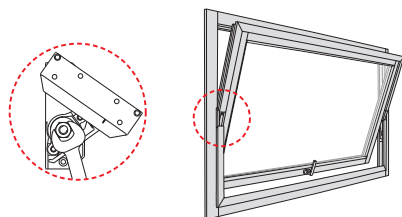

Adjust friction using a 17 mm hex wrench.

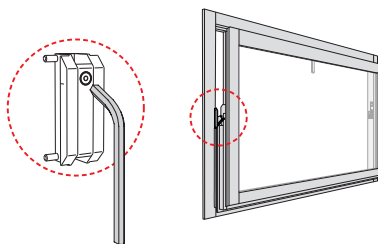

Adjust friction for 180° rotation using a 4 mm allen wrench.

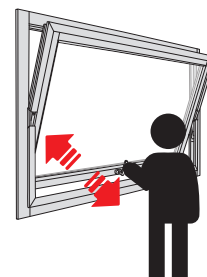

Make sure that the sash and hardware move properly

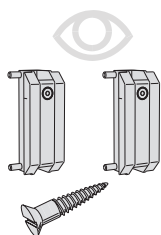

Check the fasteners and hardware for wear.

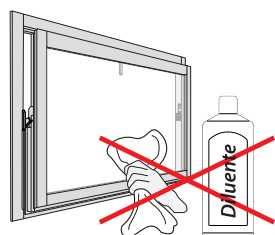

Avoid using products that could compromise the corrosion protection properties of the hardware.

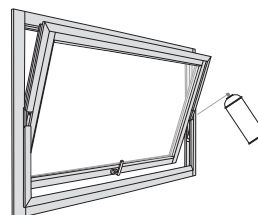

Lubricate all moving parts of the hardware with grease.



Remove any dirt accumulated in the strikers and rebates.

## Arm release for 180° window rotation

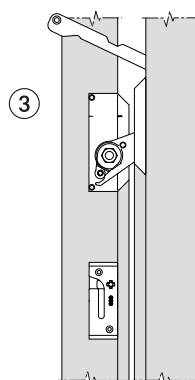
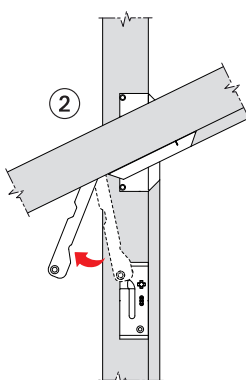
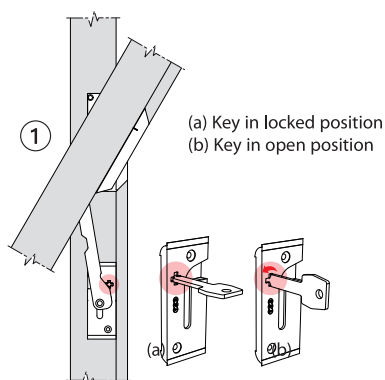

When releasing the opening restrictor ①, unhooking the restrictor arm ② and 180° rotation of the sash ③, be very careful to not put your hands or other body parts between the arm, sash, and frame: risk of personal injury.

## FAQ

Problem	Things to check	Solution
Closing difficulties	Check that the handle operates properly.	Contact specialised personnel to replace handle.
	Check that the hardware is properly aligned.	If it is incorrectly aligned, call on specialised technicians to adjust the hardware.
	Check for foreign objects that could prevent the hardware from sliding properly.	Remove the obstacles.
Loss of sash friction	It is possible that the sash does not stay in the desired position.	Contact specialised personnel to repair the door or window.

Store this operation and maintenance manual near the windows, so that it is readily available at all times. Make sure to scrupulously observe all operation and maintenance warnings in this manual to prevent injury to persons and damage to property. If necessary, affix a striker to the window with instructions on how to use it.



Alban Giacomo spa  
Via A. De Gasperi, 75  
36060 Romano d'Ezzelino (VI) Italy  
+39 0424 832 832  
[www.agb.it](http://www.agb.it) - [info@agb.it](mailto:info@agb.it)

MADE IN ITALY

MADE IN ITALY